

Butler Fasteners

Tel: 0115 950 0090 Fax: 0115 9500095 Email: sales@butlerfasteners.co.uk

COILED SPIRAL SPRING PINS

Coiled Spiral Spring Pins consist of 2 1/4 coils of spring steel or stainless steel and have swaged chamfers at each end. They are designed for plain drilled holes but countersinking makes insertion easier. The advantages of coiled pins are:



- Improved shock absorption as the load is spread over more than one coil
- Assembly is easier as the insertion force needed is lower
- Coiled Spiral Spring Pins cannot interlock when in bulk

There are two strength duties, standard (ISO 8750) and heavy (ISO 8748).

Standard duty is preferred for most applications, but heavy duty is recommended for applications in hardened steel components where maximum shear strength is

MATERIALS

SPRING STEEL

CS 67 and DIN 17222, hardened and tempered to HV 420-520

STAINLESS STEEL A2

STANDARDS

ISO 8750

Standard Duty

ISO 8748

Heavy Duty

FINISHES

- Self Colour
- Zinc Plated

Where electrolytically applied finishes are used it is essential to de-embrittle the pins immediately after plating. For safety-critical applications non-electrolytic finishes should be used as the de-embrittlement process is not 100% reliable.

SIZE RANGE – COILED PINS

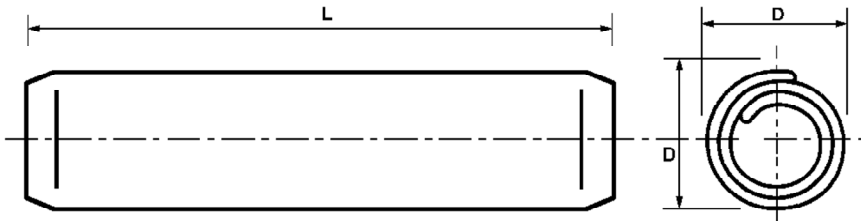

Nominal Diameter	0.8	1	1.2	1.5	2	2.5	3	3.5	4	5	6	8	10	12	14	16	
Available Materials	Spring Steel CS70 In All Diameters																
	Stainless Steel A2																
Expanded Diameter 'D'																	
Standard Duty Max ISO 8750	0.91	1.15	1.35	1.73	2.25	2.78	3.30	3.84	4.40	5.50	6.50	8.63	10.80	12.85	14.45	16.45	
Standard Duty Min	0.85	1.05	1.25	1.62	2.13	2.65	3.15	3.67	4.20	5.25	6.25	8.30	10.35	12.40	14.95	17.00	
Heavy Duty Max ISO 8748				1.71	2.21	2.73	3.25	3.79	4.3	5.35	6.40	8.55					
Heavy Duty Min				1.61	2.11	2.62	3.12	3.64	4.15	5.15	6.18	8.25					
Recommended Hole Size Max	0.84	1.04	1.24	1.60	2.10	2.60	3.10	3.62	4.12	5.12	6.13	8.17	10.20	12.22	14.25	16.25	
Recommended Hole Size Min	0.80	1.00	1.20	1.50	1.99	2.49	2.99	3.48	3.98	4.95	5.95	7.93	9.93	11.90	13.85	15.85	
Minimum Double Shear Strengths – tested to ISO 8749, kN (see also Page 37)																	
Carbon Steel Standard Duty	0.4	0.6	0.9	1.45	2.5	3.9	5.5	7.5	9.6	15	22	39	62	89	120	160	
Carbon Steel Heavy Duty				1.9	3.5	5.5	7.6	10	13.5	20	30	53					
A2 Stainless Steel Standard Duty				1.05	1.9	2.9	4.2		7.6	11.5	16.8	30					
Lengths (ISO 8750) Steel																	
4																	
5																	
6																	
8																	
10																	
12																	
14																	
16																	
18																	
20																	
22																	
24																	
26																	
28																	
30																	
32																	
35																	
40																	
45																	
50																	
55																	
60																	
65																	
70																	
75																	
80																	
85																	
90																	
95																	
100																	
120																	
140																	
160																	
180																	
Length Tolerances	1 – 10 mm long ± 0.25					12 – 50 mm long ± 0.50					Over 50 mm long ± 0.75						